



Description

Track supporting girders sustain complex stresses and the link between girders and column must cope with relative movements along 3 axes :

- vertical loads **R_v** will cause girder deflections and its ends rotate along the **Y** axis.
- direction movements of the crane trolley, as well as suspended loads balancing, crane skewing and imperfect rail alignment generate transverse horizontal loads **R_h** and horizontal girder bending along vertical **Z** axis.
- the combination of the above mentioned 2 movements causes the ends of the girder to rotate along **X** axis.

The solution is a link with bearings like the surge connector : its bearings allow a rotation of about 5° in all directions, and simultaneously can cope with induced stresses.

Three designs are available :

- type **G** : manufactured acc. to standard dimensions with bearings housings directly machined in the connector;
- type **GP** : manufactured acc. to the customer's specifications (non-standard dimensions), with the bearings inserted in the connector.
- type **GPA** : manufactured in 2 halves for special mounting. Please contact us.

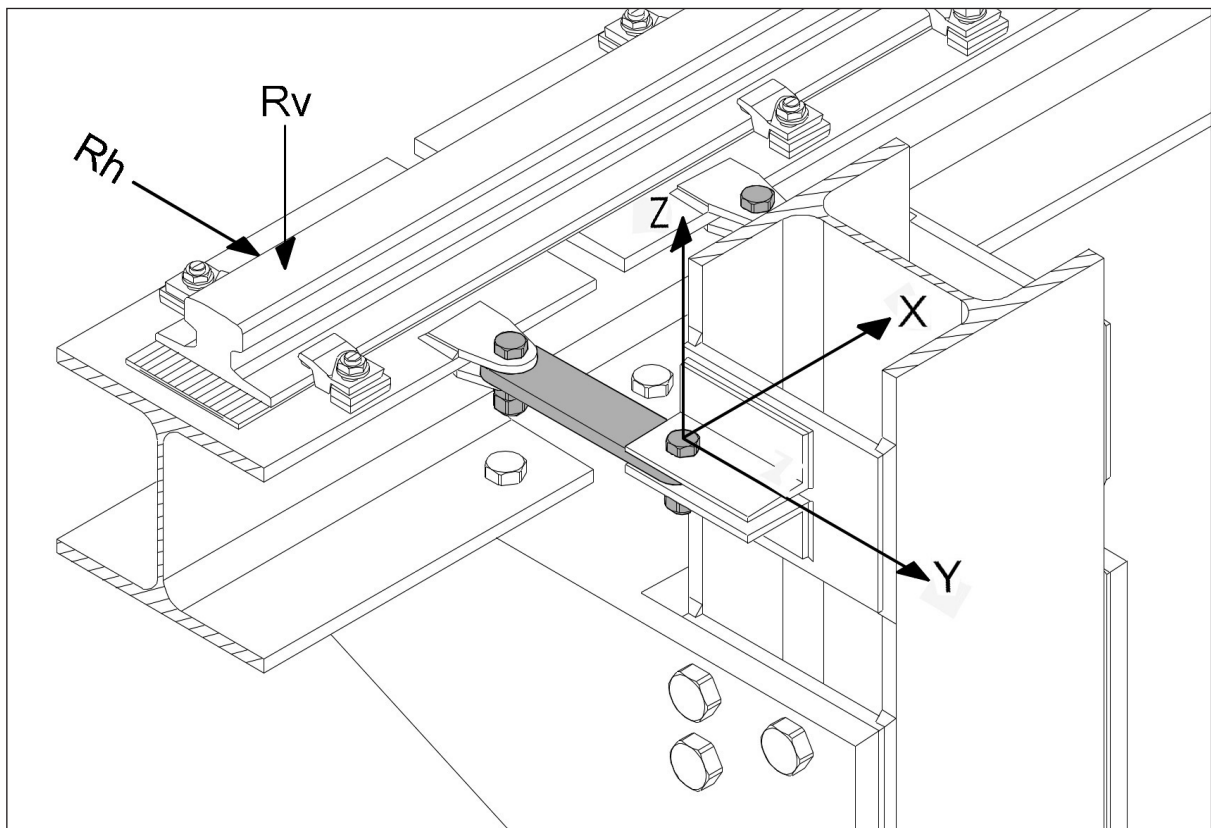



Dimensions

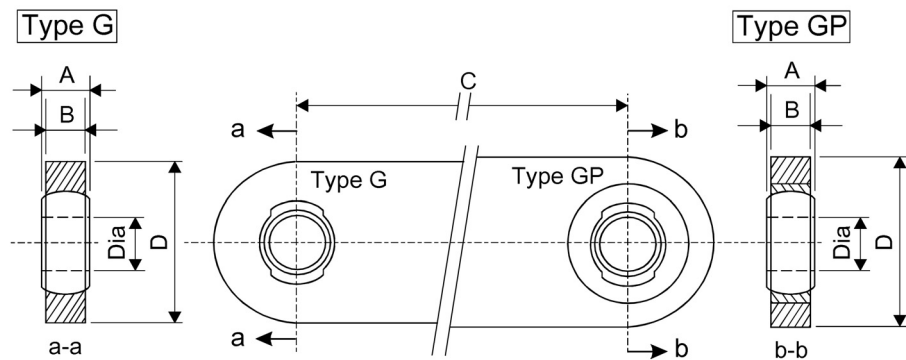

Sizes and admissible working loads based on surge connectors in S 355 J2G3 steel grade, acc. to EN 10025.

Type	Nominal diameter mm	Dimensions mm				Working load kN	O-ring example mm	Tightening torque Nm
		A	B	C				
				min	max			
G 128	20	22	19	60	230	70	30 x 1,5	150
GP 128	20	22	20	70	*	80		150
G 119	24	32	26	75	330	80	39 x 3	450
GP 119	24	32	25	85	*	100		450
G 122	30	38	28	80	315	100	48 x 4,5	850
GP 122	30	38	30	100	*	120		850
G 123	42	41	33	100	310	170	57 x 4,5	1400
GP 123	42	41	30	115	*	180		1400
G 130	48	51	38	140	305	180	73 x 6	3000
GP 130	48	51	40	150	*	200		3000
G 131	56	59	45	165	295	200	85 x 7	4500
GP 131	56	59	50	160	*	220		4500

* For selecting the most appropriate C dimension of a GP type, please consult us.

Installation

The installation of GANTREX® surge connectors is very straightforward and mainly depends on the global design of the fixing system. The few suggestions hereafter should help to an efficient installation :

- The surge connector is supplied with 2 permanently lubricated spherical bearings; these may in no way be removed from the connector.
- The bore in the bearings are manufactured with a tolerance of +0,05/-0,00 mm.
- Screws steel grade 8.8 must be used. Bolts will have the same nominal diameter as the bores in the bearings and will be acc. to DIN 931 with the shank being long enough to ensure that there are no threads in the shear planes on either side of the bearing.
- It is recommended that neoprene "O-ring" be placed on both sides of the bearings.
- Surge connectors are pre-assembled with their brackets in order to ease the installation.
- Bolts must always be inserted with the head up.
- Self-locking nuts are recommended.
- Cut-outs between bearings and surge connectors should face downwards.

On request, we can supply application examples.

Our Technical Department is at your disposal to develop the most appropriate design in function of your particular problem.

We reserve the right to discontinue or change specifications or design at any time without prior notice and without incurring any obligation whatsoever.



GANTREX S.A.

rue du Commerce 19 • 1400 Nivelles • Belgium

Tel. : +32(0)67.88.80.30 • Fax : +32(0)67.21.63.21 • E-mail : info@be.gantry.com

http://www.gantry.com